



Campus Conversation 2.0

# Research, Economic Development & Knowledge Enterprise

Dr. Taylor Eighmy  
February 20, 2019

The left side of the slide features a vertical column of decorative wavy lines. There are approximately 15 lines in total. Most are blue, but two are orange. The lines are arranged in a roughly vertical sequence, with some appearing in pairs or small groups.

# Updates & Recent Accomplishments

# Biennial Budget

---



# New Campus Senior Leadership

---



**Myron Anderson**

Vice President for  
Inclusive Excellence



**Veronica Mendez**

Vice President for  
Business Affairs



**Kendra Ketchum**

Vice President for  
Information Management &  
Technology



**LT Robinson**

Interim Dean of Students



# Urban Education Institute Foundational Gift

Finding solutions for  
San Antonio's urban  
education challenges

**\$2.0 million**

**RAISE**<sup>®</sup>  
YOUR HAND TEXAS  
FOUNDATION



Graham Weston  
**\$15 Million Gift**

For UTSA's proposed  
School of Data Science



# Expanding the Downtown Campus **Land Transfers Valued at \$13 Million**

Parcels from the City of San Antonio and Bexar County for the National Security Collaboration Center, the School of Data Science and a new home for the College of Business



Architect selected  
**School of Data  
Science &  
National Security  
Collaboration Center**

---



# **JACOBS<sup>®</sup>**

# **OVERLAND**





# Civic Discourse and Engagement

[utsa.edu/civicdiscourse](https://utsa.edu/civicdiscourse)

## Resources

- Trainings
- Workshops
- Guests Speakers
- Curriculum Integrations
- Programming

## Academic Focus

- Library Guides
- Academic Inquiry & Scholarship
- Honors College / Top Scholars
- COPP Civic Engagement Minor



# Diversity and Inclusion at UTSA

[utsa.edu/diversity](https://utsa.edu/diversity)

## Resources

- Trainings
- Workshops
- Guests Speakers
- Curriculum Integrations
- Programming

## Academic Focus

- Library Guides
- Academic Inquiry & Scholarship
- Honors College / Top Scholars
- COPP Civic Engagement Minor



UTSA®

---

# Strategic Implementation Plan

# 10 Aspirant Peer Models of Excellence



UC SANTA CRUZ



Carnegie RI  
Institutions

UMBC



# UTSA in 10 Years

---

**4+**

thriving campuses, with more under consideration

**>>45,000**

students

**>2,000**

faculty

**>>85%**

first-year retention rate

**6-8**

areas of scholarly distinction

**R1**

Carnegie classification, with access to the National Research University Fund

**>\$300M**

in annual research expenditures

**>>\$400M**

endowment

**>>35%**

four-year graduation rate

**>>\$1B**

annual budget

**>300**

endowed chairs/professorships

**>15**

faculty in the national academies

**>25**

faculty receiving prestigious awards annually

**>>60%**

six-year graduation rate

**>3 million ft<sup>2</sup>**

new construction across campuses

## UTSA's 10-Year Destinations

---

A model for  
student success

A great public research  
university

An exemplar for **strategic  
growth and innovative  
excellence**



# A model for student success

UTSA is a next generation Hispanic-thriving, multicultural institution where students from all backgrounds can excel. As a prosperity engine graduating world-engaged civic leaders of tomorrow, UTSA provides students with exceptional opportunities for experiential learning and classroom to career education.

A MODEL FOR STUDENT SUCCESS

# First-Year Retention

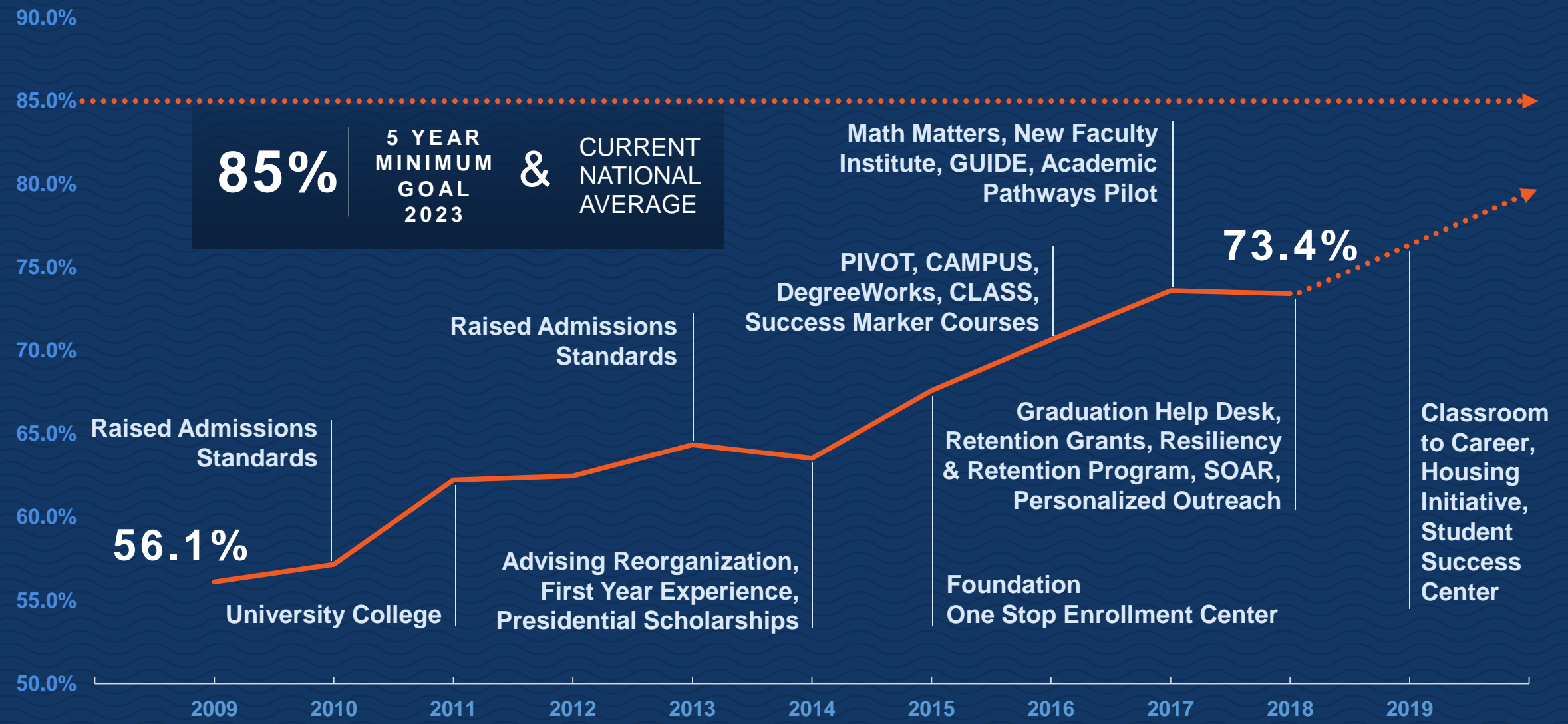

**85%** 5 YEAR MINIMUM GOAL 2023 & CURRENT NATIONAL AVERAGE

Data as reported to the Integrated Postsecondary Education Data System (IPEDS)



# Second-Year Persistence

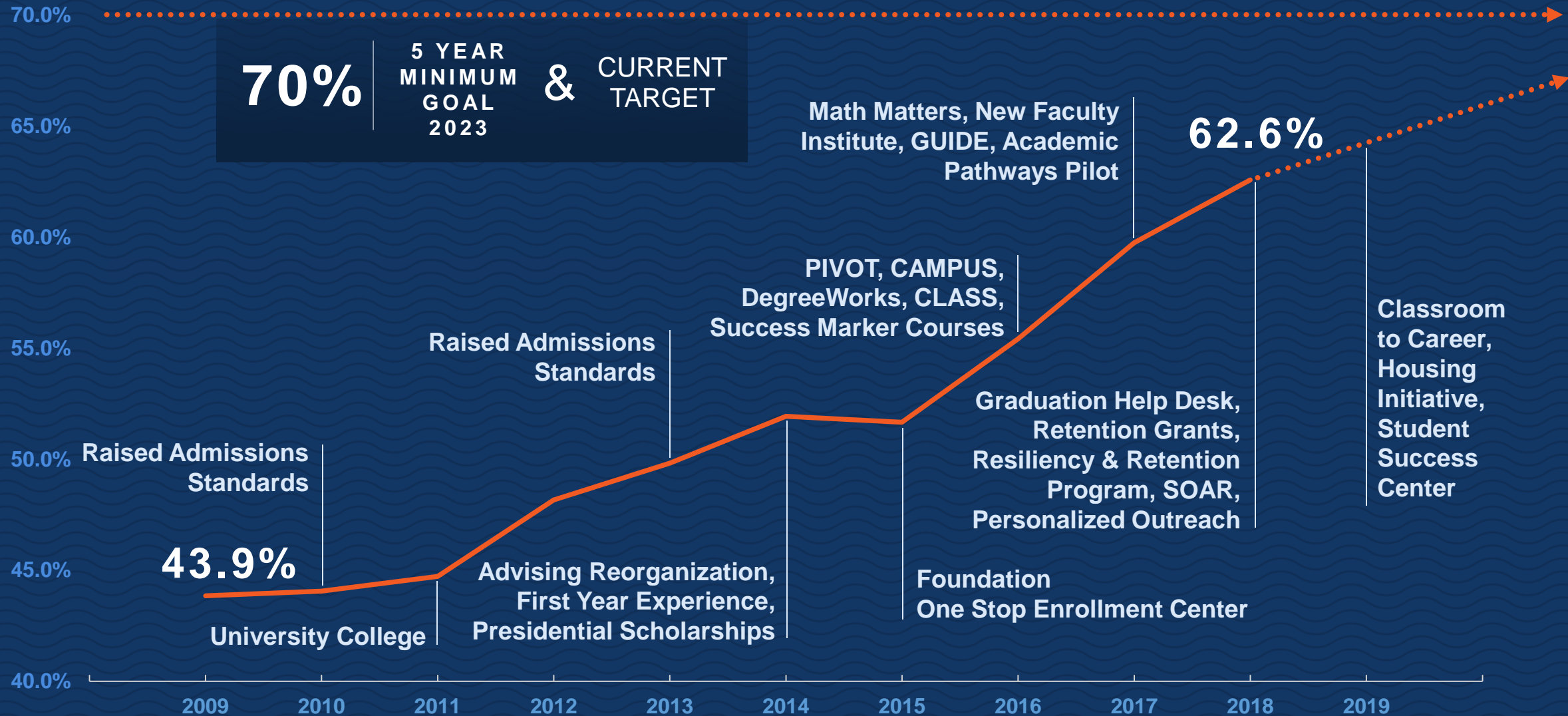

Data as reported to the Integrated Postsecondary Education Data System (IPEDS)

A MODEL FOR STUDENT SUCCESS

# Third-Year Persistence

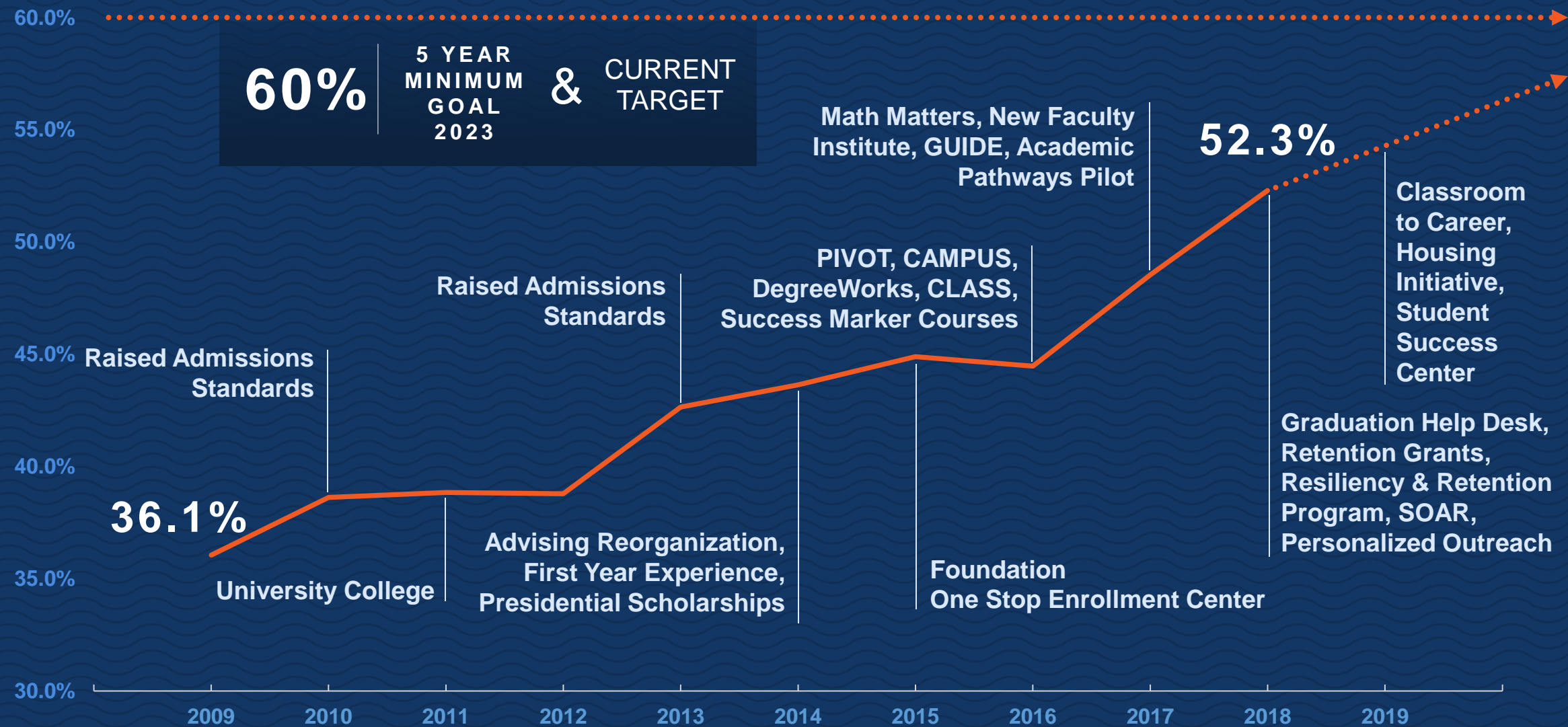

**60%** | 5 YEAR MINIMUM GOAL 2023 & CURRENT TARGET

Data as reported to the Integrated Postsecondary Education Data System (IPEDS)

A MODEL FOR STUDENT SUCCESS

# Four-Year Graduation Rates

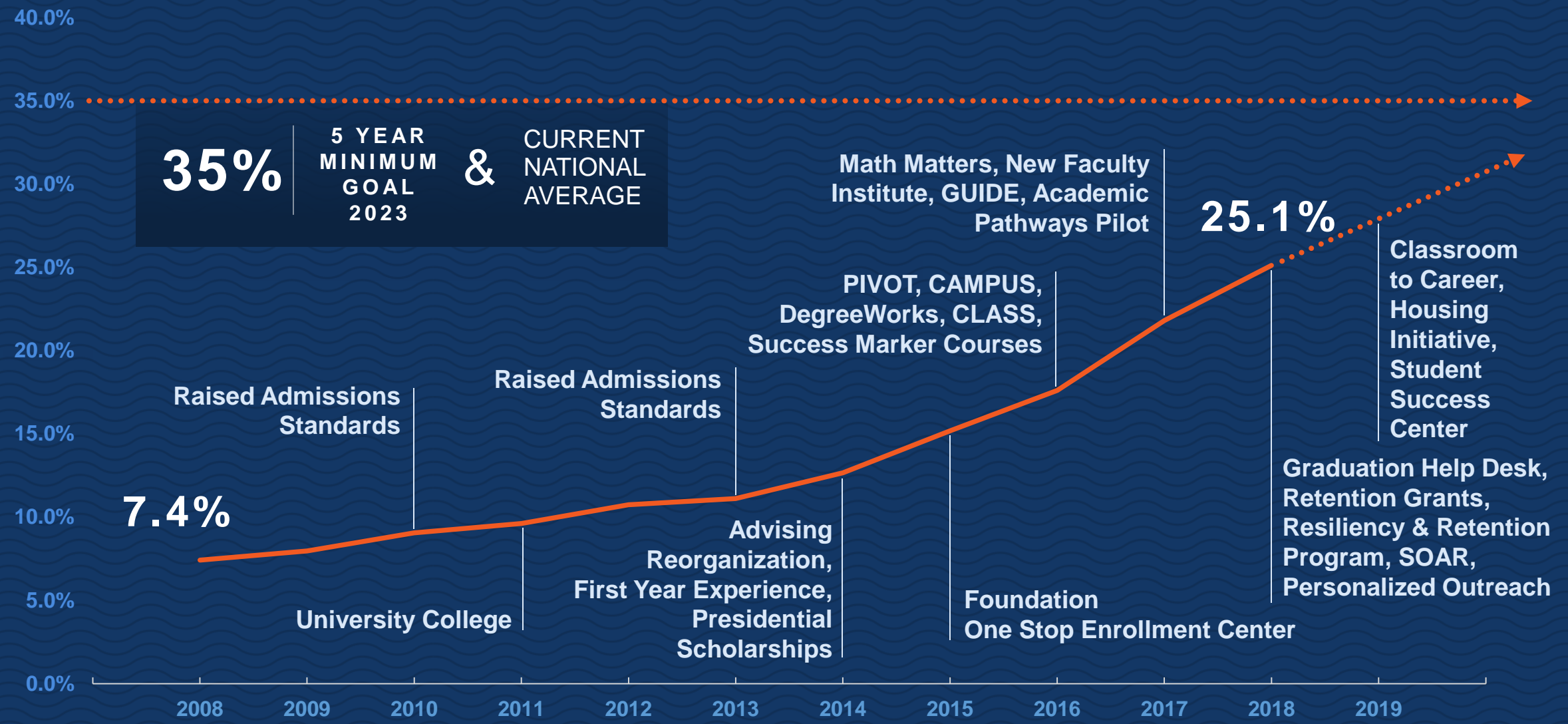

Data as reported to the Integrated Postsecondary Education Data System (IPEDS)

## A MODEL FOR STUDENT SUCCESS

# Six-Year Graduation Rates

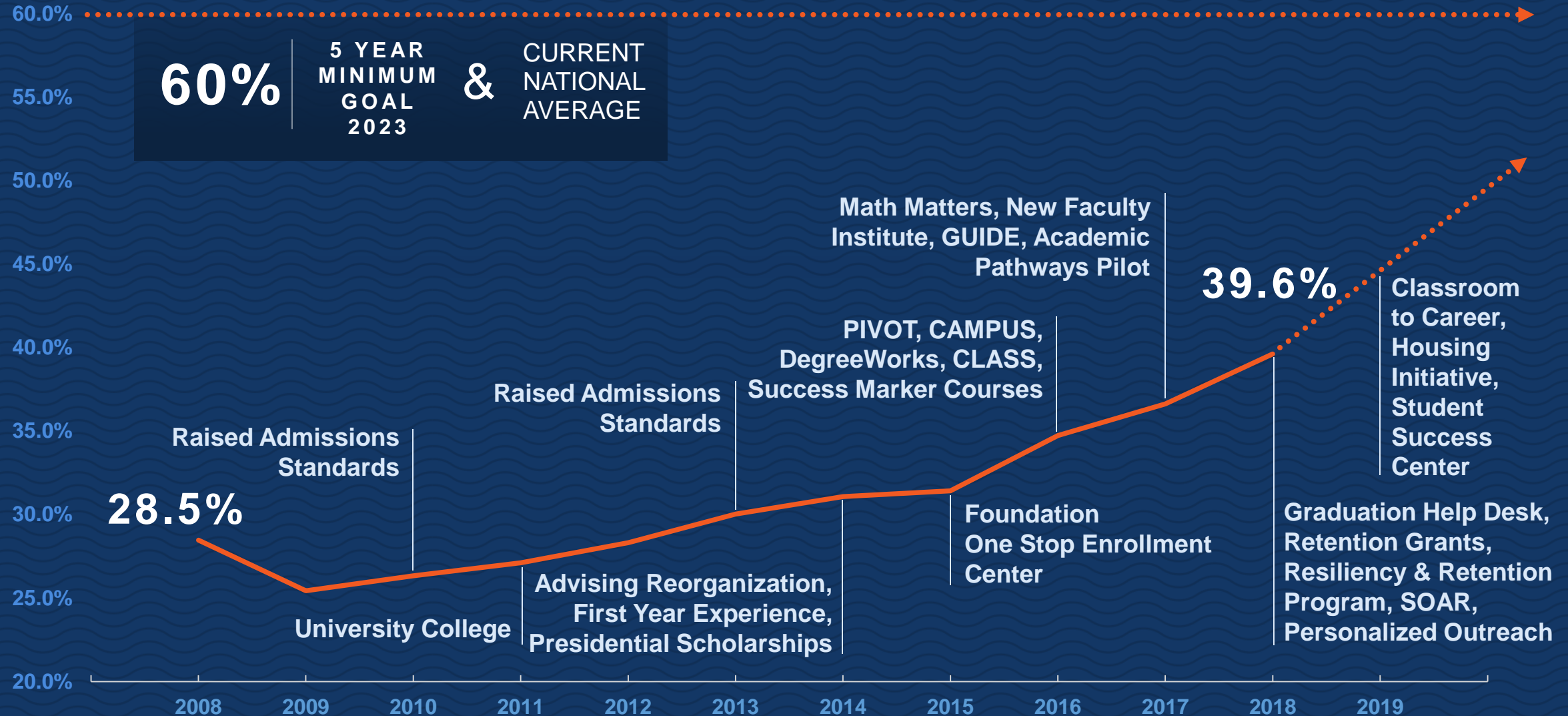

Data as reported to the Integrated Postsecondary Education Data System (IPEDS)



# A great public research university

With a focus on driving San Antonio's knowledge economy, UTSA is an urban-serving university of the future living out the notion that great universities need great cities, and great cities need great universities. As a discovery enterprise on the fast track to attaining National Research University Fund eligibility and an R1 designation by the Carnegie Commission, UTSA is positioned to align with members of the prestigious Association of American Universities.

A GREAT PUBLIC RESEARCH UNIVERSITY

# UTSA's Trajectory



## A GREAT PUBLIC RESEARCH UNIVERSITY

Tenure and tenure-track UTSA faculty with degrees from AAU and R1 Institutions

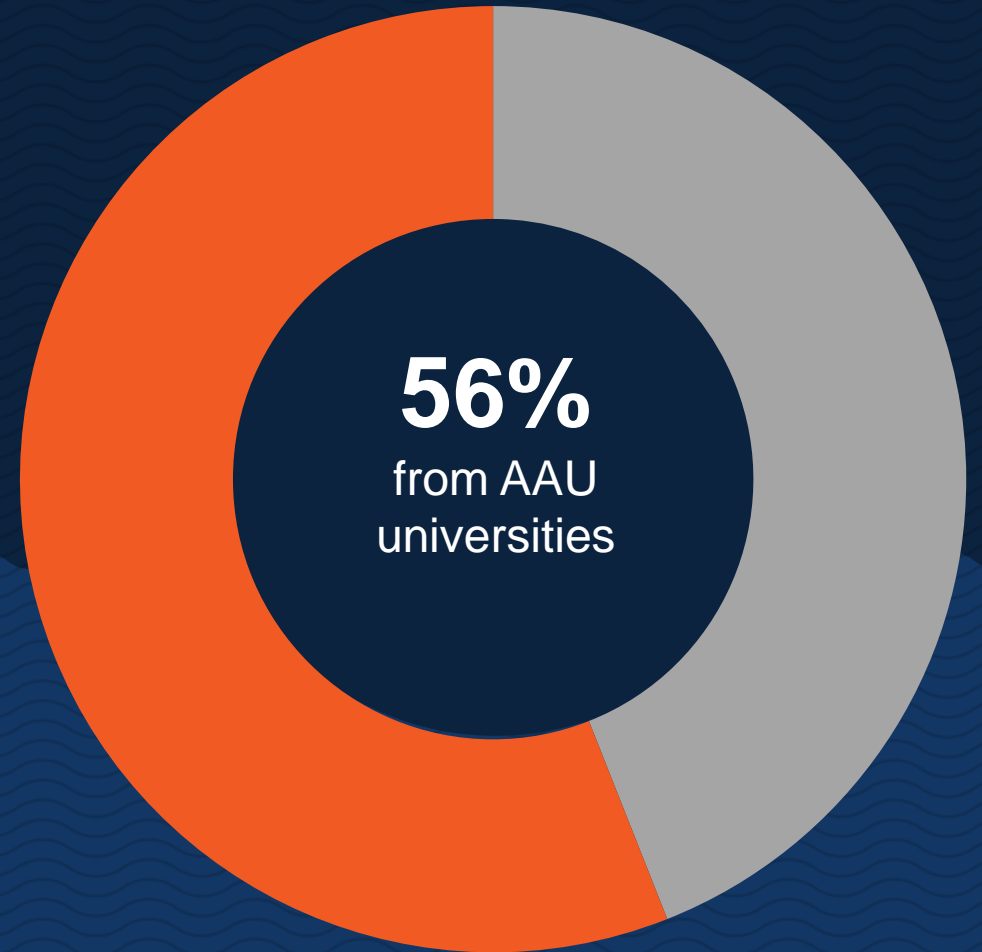
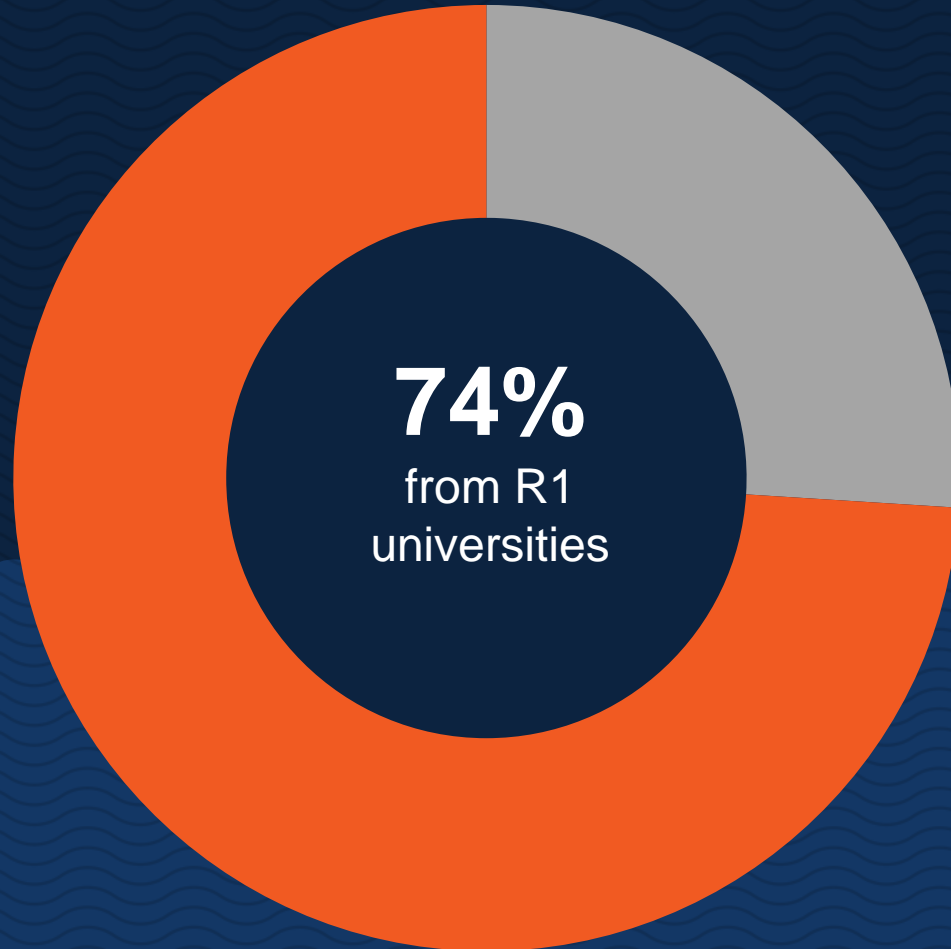

A GREAT PUBLIC RESEARCH UNIVERSITY

## Graduate Students Rising Enrollment

**36.2%**  
Increase

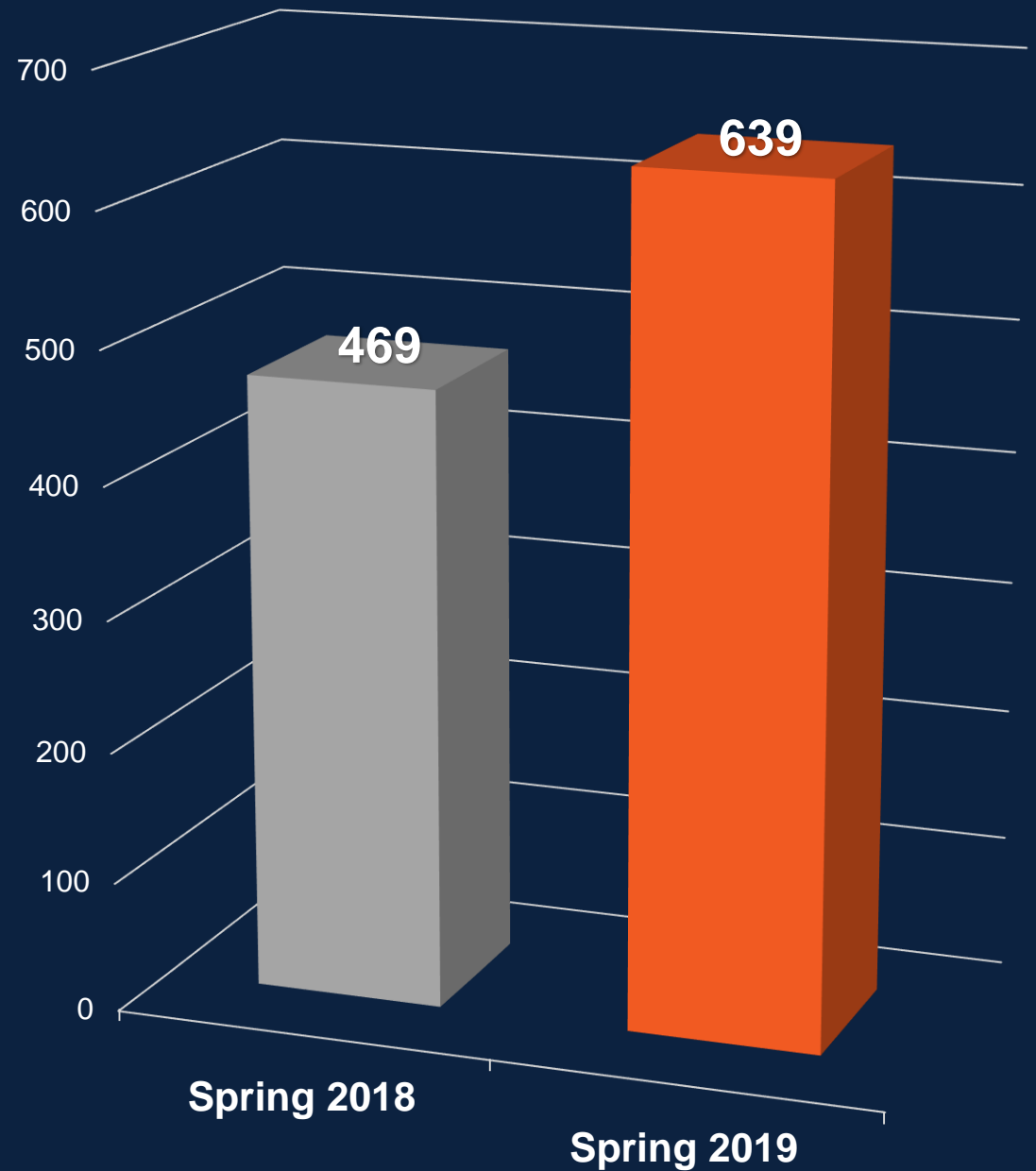



A GREAT PUBLIC RESEARCH UNIVERSITY

# UTSA's Research Momentum

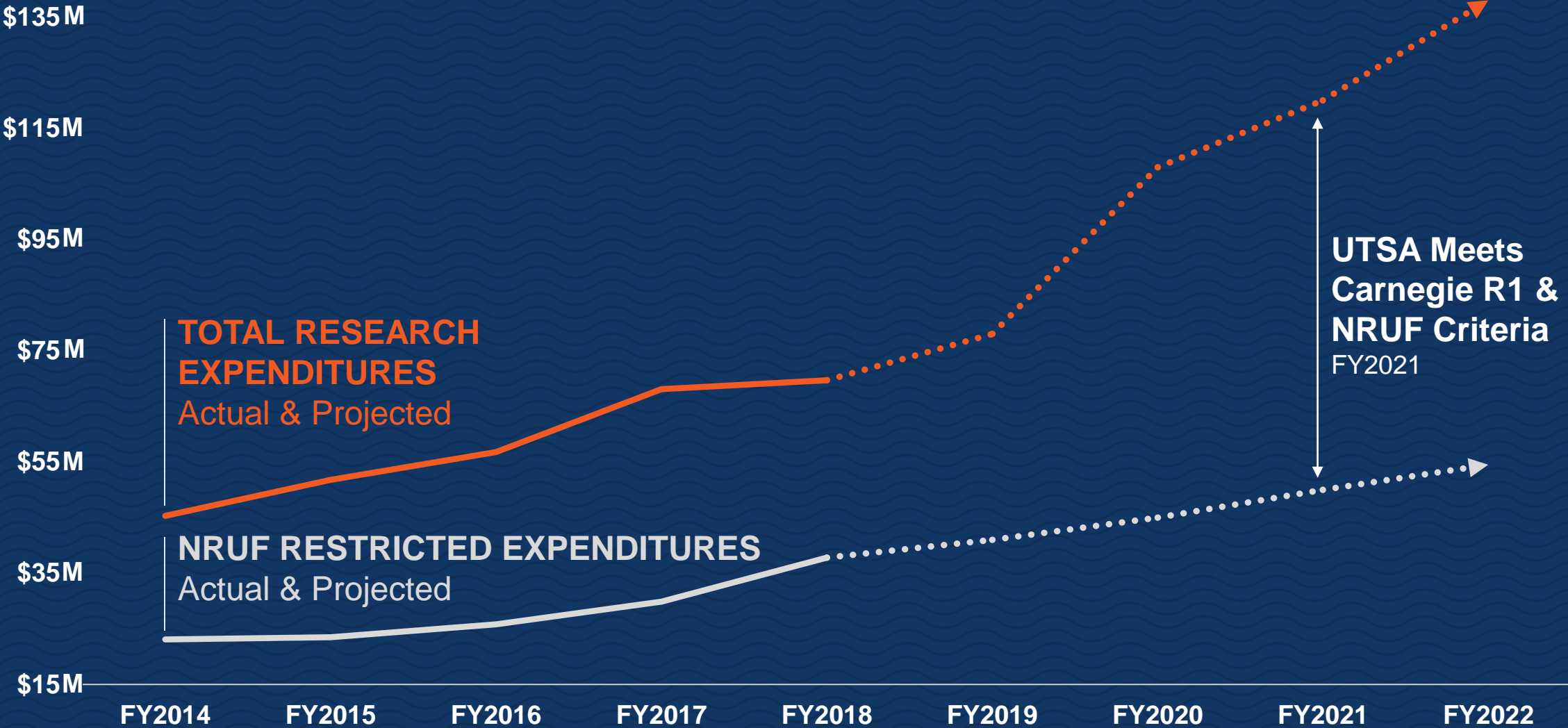

# Pathway to Carnegie R1

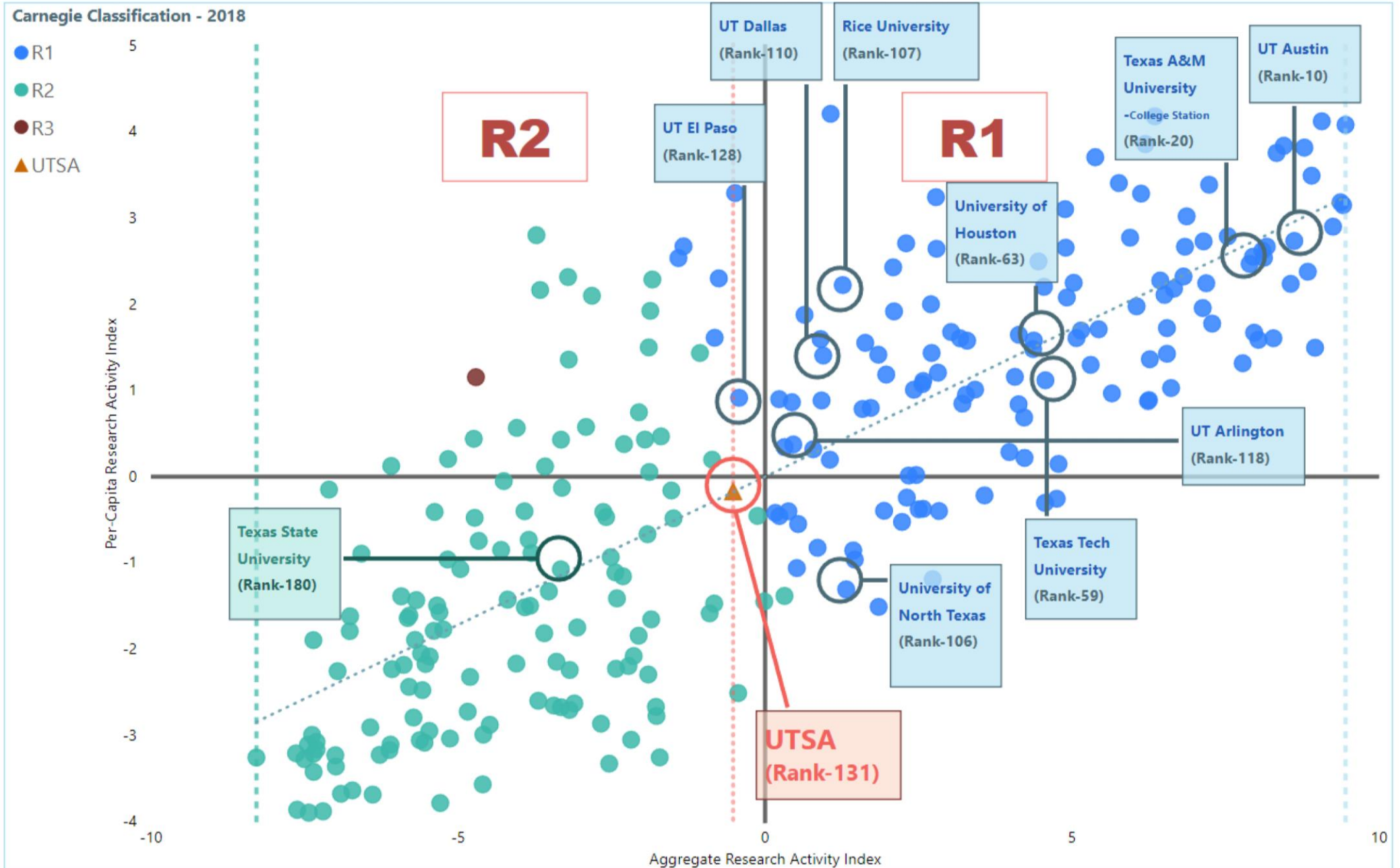



# An exemplar for **strategic growth and innovative excellence**

UTSA will realize its full potential as a university by growing to become a more comprehensive institution. By focusing on nimbleness and continuous improvement, UTSA integrates innovative approaches and best practices to ensure goals align with operational processes. With a reputation as a great place to work, UTSA actively cultivates the excellence of its people.

STRATEGIC GROWTH & INNOVATIVE EXCELLENCE

# UTSA's Enrollment Growth

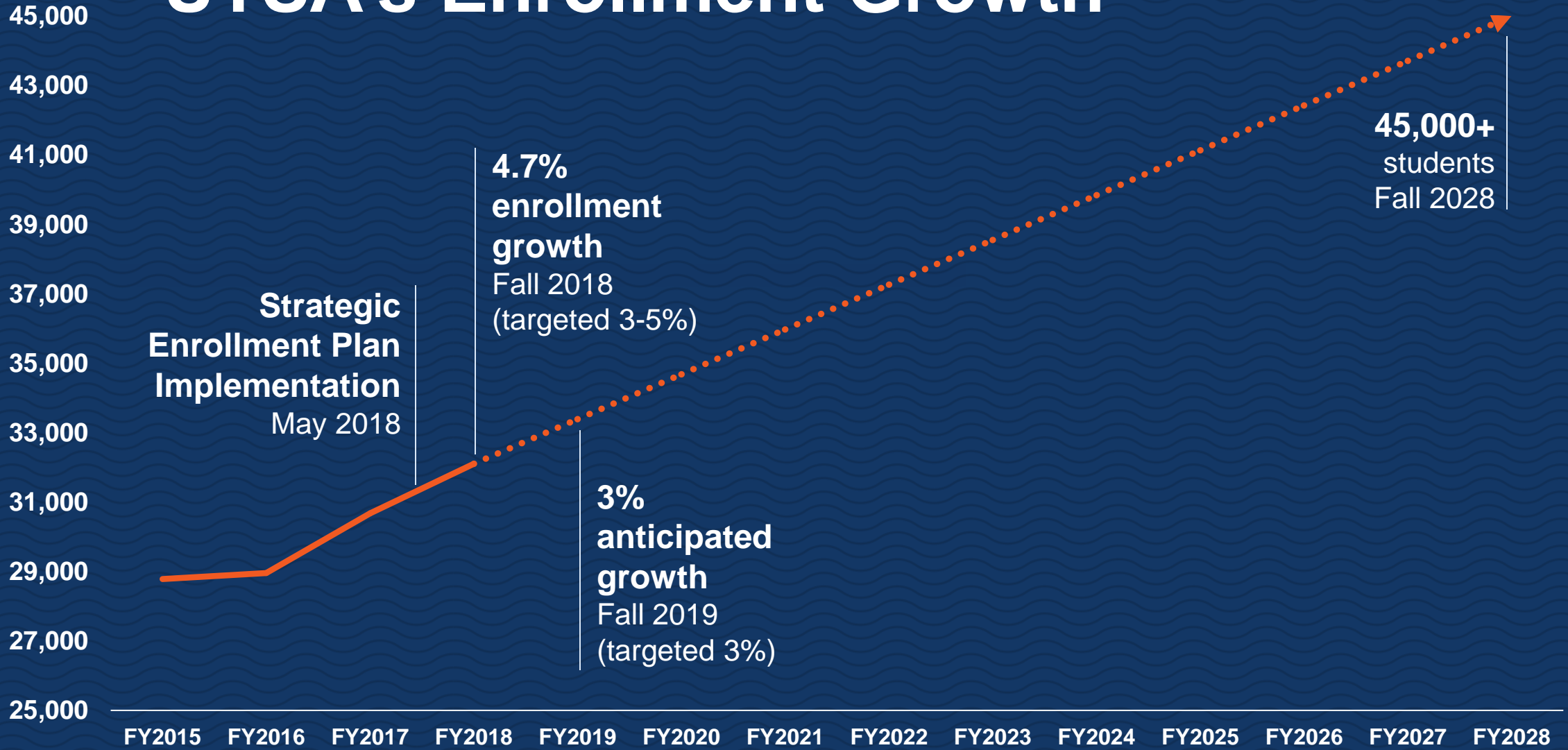

STRATEGIC GROWTH & INNOVATIVE EXCELLENCE



# UTSA<sup>®</sup> Transfer Credit Calculator

---

Simplifies transfer admissions, making it  
easy to determine which credits will  
transfer to UTSA



STRATEGIC GROWTH & INNOVATIVE EXCELLENCE

On the Horizon  
**Workplace  
Satisfaction Survey**

---

Recognizing the importance of staff by  
ensuring UTSA is a great place to work





---

# Reimagining the Downtown Campus



San Antonio River

Pearl

San Antonio Riverwalk

Hemisfair Park

St. Paul's Square

Alamodome

San Pedro Creek Cultural Park

Alameda Theater

Frost Tower

**UTSA**  
Downtown Campus

*Zona Cultural*

San Antonio River  
San Pedro Creek

Riverwalk

**UTSA**  
Institute of Texan Cultures

H-E-B  
Headquarters

Site of New  
Federal Courthouse

San Antonio Missions

Southtown

500 ft



**Frio Street Properties**  
14.3 acres

**Cattleman's Square Residential Tower**

**Continental Hotel Residences**

**Proposed Downtown Campus | 8.08 acres**

**Current Downtown Campus | 18.3 acres**

**New National Security Collaboration Center**

**Expanded College of Business**

**New School of Data Science**

# Ten Year Plan 2018-2028

**PHASE 1: 2018-2023**

**PHASE 2: 2023-2028**

**San Pedro Creek**





UTSA®

---

# Strategic Initiatives

# Campus Master Plan

---

Guiding the development  
of UTSA's campuses  
over the next decade



## ACREAGE

# UTSA Campuses

- 758 total acres
- 573 developable acres



**Main Campus**  
*600 acres | 495.2 developable acres*

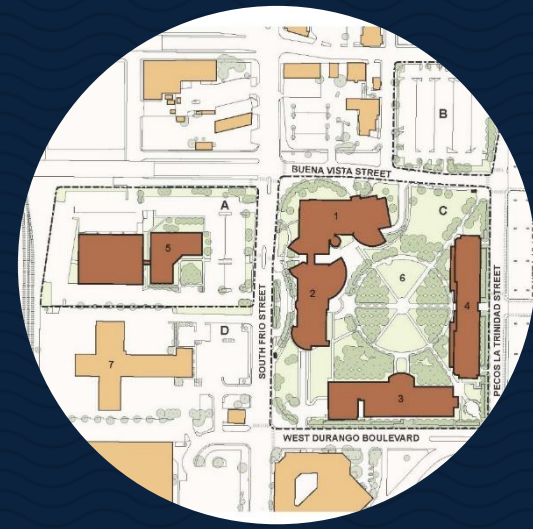

**Downtown Campus**  
*18.3 acres | 8.3 developable acres*



**Park West Campus**  
*125 acres | 70 developable acres*



**Institute of Texan Cultures**  
*14.6 acres | 0 developable acres*

# Capital Campaign

---

Providing UTSA with the infrastructure and resources to achieve recognition as a model for student success and research discovery



# Roadrunner Village

---

A vibrant new neighborhood featuring housing, dining and retail space that enhances the campus experience for the university community.



# Guadalupe Hall

---

Designed with student success in mind, UTSA's newest residence hall will house 372 freshmen



# Residential Honors College

---

A new residence hall for the university's top students, bringing UTSA's Honors College to new levels of national prominence





# Roadrunner Athletics Center of Excellence

A comprehensive multipurpose sports center to address student-athlete academic success, safety, performance and wellness

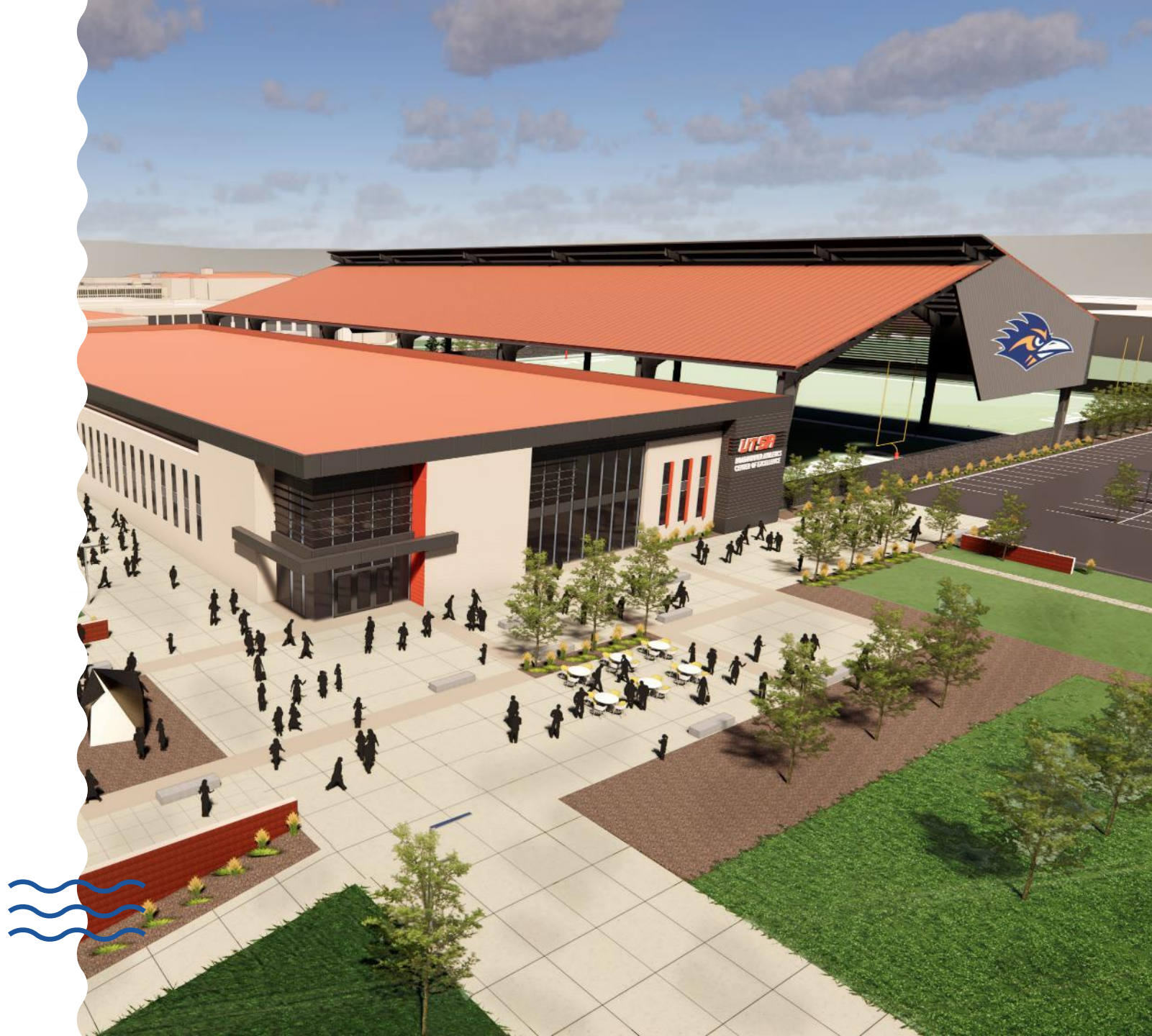

# School of Data Science

---

Centralizing UTSA's talent and resources in cyberscience, data science and data management into one powerful new school



Columbia University  
Data Sciences Institute

# National Security Collaboration Center

---

Solving the nation's  
greatest cybersecurity  
threats



# Expanding the College of Business

---

A second location to accommodate rapid enrollment growth, situated in the heart of San Antonio's business community



Portland State University  
School of Business

# Cattlemen's Square Residential Tower

---

A mixed-use residential facility to house UTSA's growing population at the Downtown Campus



Arizona State University  
Taylor Place Residence Hall

# Continental Hotel Residences

---

A mixed-use residential facility to house UTSA's growing population at the Downtown Campus

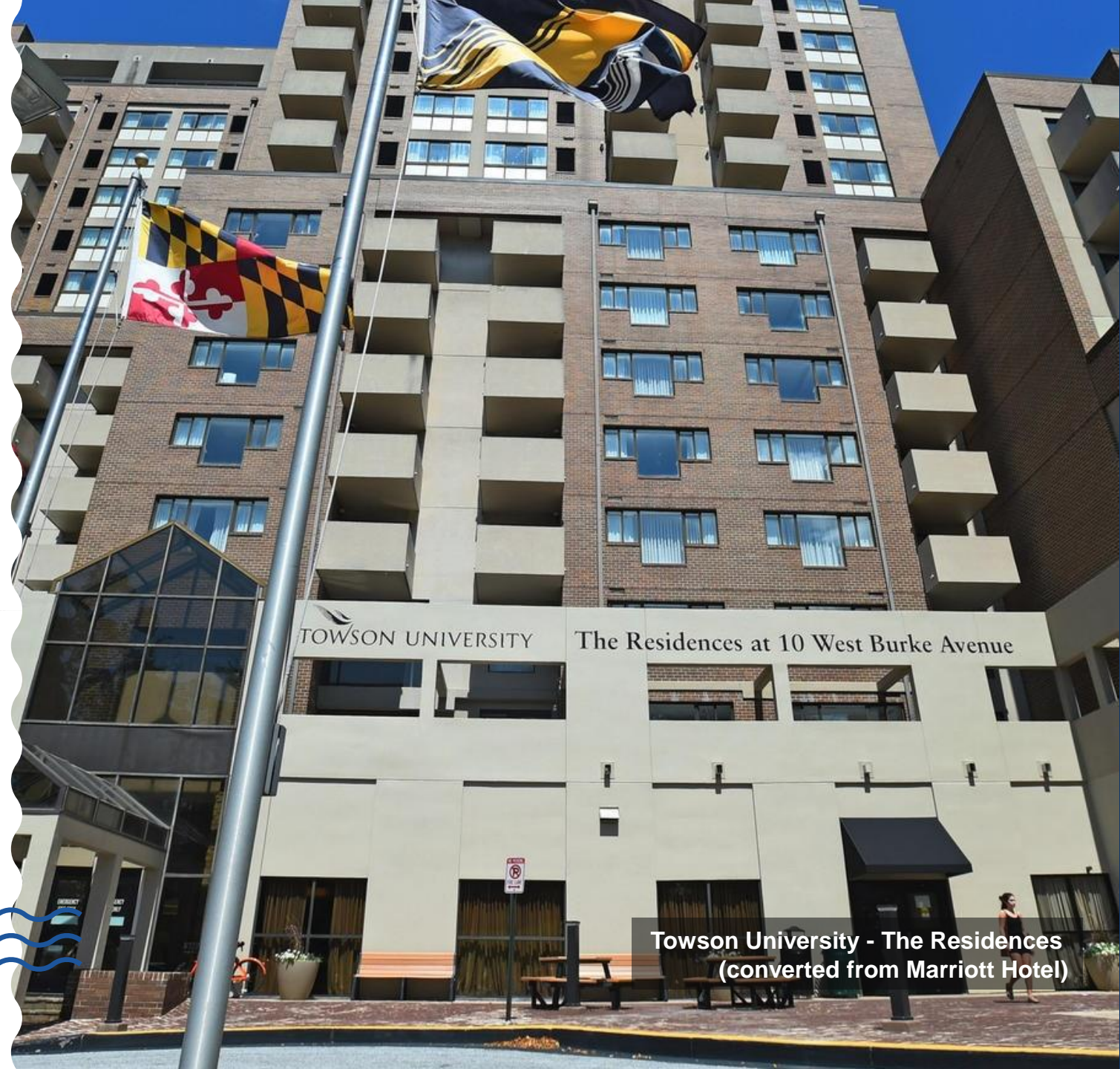

Towson University - The Residences  
(converted from Marriott Hotel)

# Classroom to Career

---

Providing transformative learning experiences such as internships, service learning, undergraduate research, study abroad and more



# Preventing Sexual Assault & Misconduct

---

A university-wide framework to ensure a safe place for all Roadrunners to study, work and live.





# Strategic Faculty Hiring for 2020

---

- Clustered and Connected Hiring
- Advancing Academic Excellence through Accelerating Faculty Diversity Hiring
- Dual Career Academic Partners Hiring
- Advancing Academic Excellence through Accelerated Hiring of Nationally Recognized Faculty
- Voluntary Separation Incentive



# Human Health

---

A new, student-centric college structure that prepares students to pursue careers in modern healthcare settings



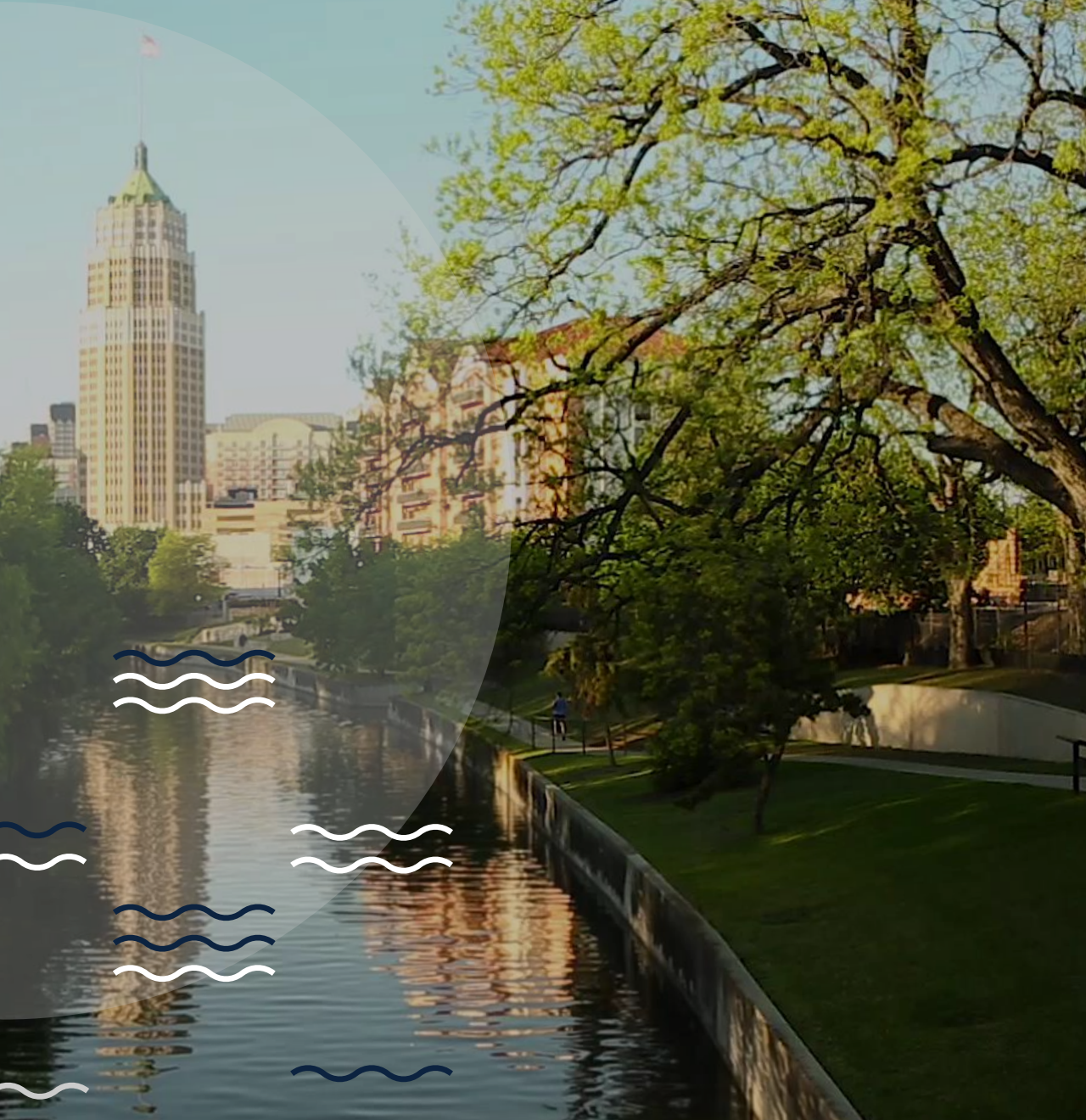

Questions?  
Thank you!